

HOSPITAL HELICOPTER AIRSPACE

INFORMATION FROM
LIVERPOOL LOCAL
ENVIRONMENTAL PLAN 2008
(SHEETS KYS 011)

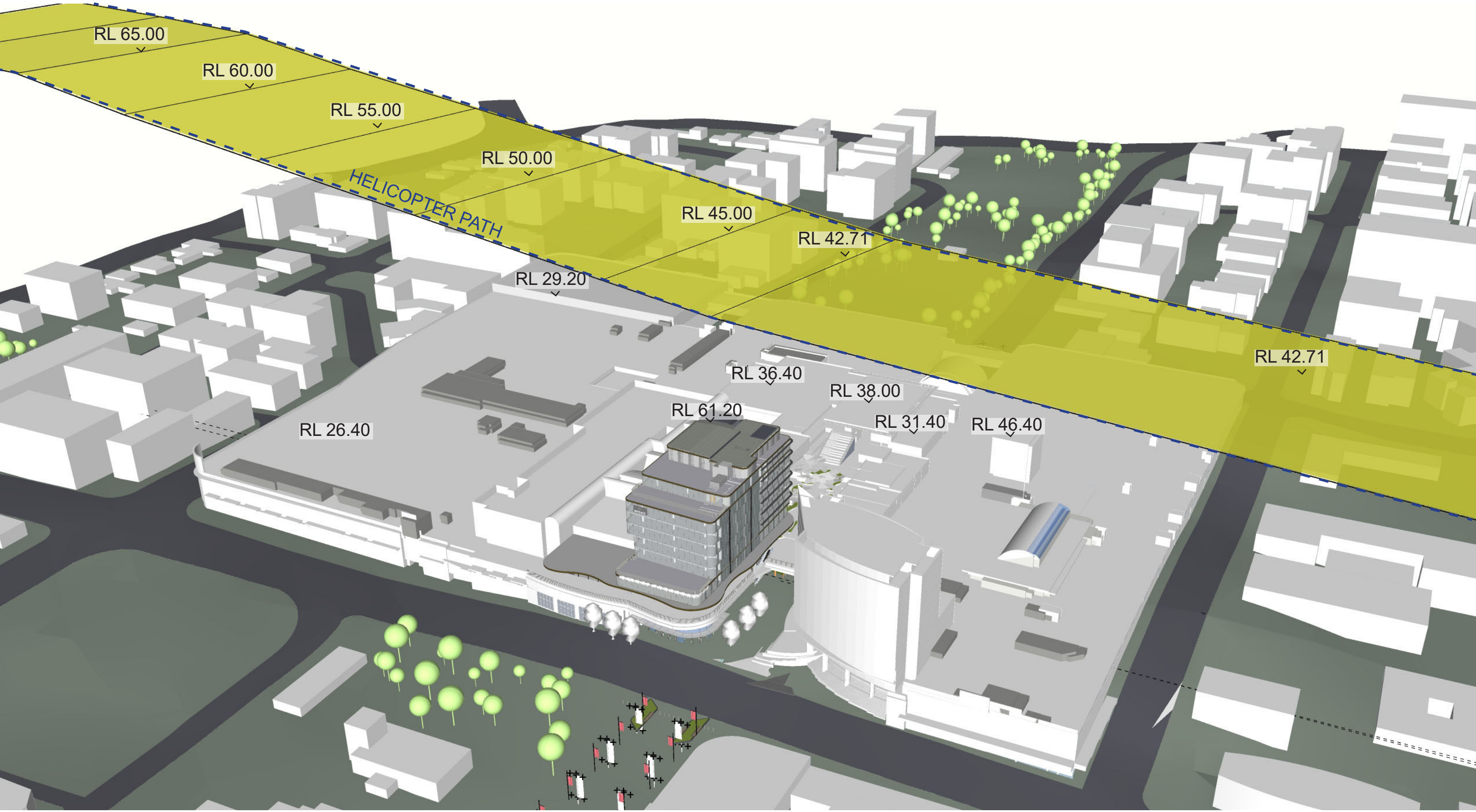

3D VIEW 1 - PROPOSED MASSING
LOOKING NE (NTS)



3D VIEW 2 - PROPOSED MASSING
LOOKING NW (NTS)

NOTES:
• This document describes a Design Intent only
• Written dimensions take precedence over scaling and are to be checked on site.
• Refer to all project documentation before commencing work.
• Refer any discrepancies to the Project Design Manager.
• Copyright is retained by Scentre Design and Construction.
• Written authority is required for any reproduction.

AMPCAPITAL

SCENTRE GROUP

Owner and Operator of **Westfield** in Australia and New Zealand
Scentre Design and Construction Pty Limited
85 Castlereagh Street Sydney NSW 2000
Phone (61) 02 9558 7000 Fax (61) 02 9558 8500
GPO Box 4004 Sydney NSW 2001
A/NZ 000 207 200

HOSPITAL
HELICOPTER
PATH SUMMARY

WESTFIELD
LIVERPOOL

DEVELOPMENT
APPLICATION RFI

Project Number: 5222
Scale: 100% @ A1
Plot Date: 13-12-2019
Drawing No.: SK04
Revision: A

